

Plant List

QTY.	SYMBOL	BOTANICAL NAME	COMMON NAME	SIZE	SPACING	SPECIFICATIONS
564	C1	CHRYSOBALANUS ICACO RED TIP	RED TIP COCOPLUM	3 GAL.	24" OC.	24" HT., 18" SPRD., FULL (1,2,3)
180	C1H	"HORIZONTAL"	DWARF GREEN COCOPLUM	3 GAL.	24" OC.	18" HT., 18" SPRD. (1,2,3)
116	TF	TRIPSACUM FLORIDANUM	DWARF FAKAHATCHEE GRASS	3 GAL.	36" OC.	24" HT., 24" SPRD. (1,2,3)
500		PASPALUM NOTATUM "ARGENTINE"	ARGENTINE BAHIA GRASS			(2,3)

QTY.	SYMBOL	BOTANICAL NAME	COMMON NAME	SIZE	SPECIFICATIONS
7	AR	ACER RUBRUM FLORIDA FULME	FLORIDA FLAMBERED MAPLE	45 GAL. CONT.	12'-14' HT., 5' SPRD., 6' CT., MIN. 2" DBH (1,2,3)
2	CB	CORDIA BOISSIERI	WHITE GLENER	65 GAL. CONT. OR B&B	10-12' HT., 8' SPRD., 5' SPRD., MIN 1 1/2" DBH (1,2)
24	CE	CONOCAPUS ERECTUS SERICEUS	SILVER BUTTWOOD	25 GAL. CONT.	STANDARD, 10-12' HT., 5' SPRD., 5' CT., 1 1/2" DBH (1,2,3)
2	CO	CHRYSOPHYLLUM OLIVIFORME	SATINLEAF	45 GAL. CONT.	12'-14' HT., 5' SPRD., 6' CT., MIN. 2" DBH (1,2,3)
16	QV	QUERCUS VIRGINIANA	LIVE OAK	45 GAL. CONT.	12'-14' HT., 5' SPRD., 6' CT., 2" DBH (1,2,3)
6	SM	SWIETENIA MAHOYONI	MAHOYANY	45 GAL. CONT.	12'-14' HT., 5' SPRD., 6' CT., 2" DBH (1,2,3)
18	SP	SABAL PALMETTO	SABAL PALM	B&B	10'-14' HT., 6' CT., 6' CT., 6' CT., 6' CT. PLANT IN STAKEHOLD HTS. (1,2,3)
13	TD	TAXODIUM DISTICHUM	BALD CYPRESS	65 GAL. CONT.	12'-14' HT., 5' SPRD., 6' CT., MIN. 2" DBH (1,2,3)

1. NATIVE PLANT MATERIALS
2. DROUGHT TOLERANT
3. ECOLOGICALLY SIGNIFICANT

Planting Notes:

COMMERCIAL FERTILIZER:

FERTILIZER SHALL BE COMPLETELY ORGANIC. IT SHALL BE UNIFORM IN COMPOSITION, DRY AND FREE FLOWING. THIS FERTILIZER SHALL BE DELIVERED TO THE SITE IN THE ORIGINAL UNOPENED BAGS EACH BEARING THE MANUFACTURER'S STATEMENT OF ANALYSIS, AND SHALL MEET THE FOLLOWING REQUIREMENTS:

- SIX PERCENT (6%) NITROGEN
- SIX PERCENT (6%) PHOSPHOROUS
- SIX PERCENT (6%) POTASSIUM

FERTILIZER SHALL BE APPLIED TO ALL SHRUBS (1/3 LB. PER 3 GAL. POT. 1/4 LB. PER 1 GAL. POT.) AND GROUNDCOVERS. THE SAME FERTILIZER MIXTURE SHALL BE USED ON SOIL AT A RATE OF 5 LB. PER 1000 SQUARE FEET. A FOURTEEN PERCENT (14%) NITROGEN, FOURTEEN PERCENT (14%) PHOSPHOROUS AND FOURTEEN PERCENT (14%) POTASSIUM IS REQUIRED ON ALL TREES AND SHRUBS OVER 5'-0" IN HEIGHT (1/2 LB. PER 5'-0" OF SPREAD). AGRIFORM TABLETS WITH TWENTY PERCENT (20%) NITROGEN, TEN PERCENT (10%) PHOSPHOROUS, FIVE PERCENT (5%) POTASSIUM IN 2" GREAT SIZES SHALL BE APPLIED ALONG WITH THE FERTILIZER PRODUCTS (1 WITH 1 GAL. PLANTS, 2 WITH 3 GAL. PLANTS AND 2 TABLETS PER 1" OF TREE TRUNK CALIPER). BACKFILL MATERIAL UP THE ROOT BALL PLACE ABOUT ONE INCH (1") FROM ROOT TIPS. MAGNESIUM SULFATE SHALL BE APPLIED TO ALL PALMS AT INSTALLATION AT A RATE OF 1/2 LB. PER INCH OF TRUNK CALIPER. MANGANESE SHALL BE APPLIED AT THE SAME RATE.

MULCH:

MULCH MATERIAL SHALL BE SHREDDED CYPRESS MULCH OR APPROVED EQUAL MOISTENED AT THE TIME OF APPLICATION TO PREVENT WIND DISPLACEMENT. MULCH SHALL BE APPLIED TO A MINIMUM 3" DEPTH IN PLANTING BEDS.

SOD:

THE SOD SHALL BE FREE FROM WEEDS, FUNGUS, INSECTS AND DISEASES OF ANY KIND, CLEAN, STRONGLY ROOTED, UNIFORMLY SIZED STRIPS, MACHINE STRIPPED NOT MORE THAN TWENTY-FOUR (24) HOURS PRIOR TO LAYING.

SUBSTITUTIONS:

NO SUBSTITUTION OF PLANT MATERIAL TYPE OR SIZE WILL BE ALLOWED WITHOUT WRITTEN APPROVAL FROM THE OWNER. CONTAINER GROWN MATERIAL WILL NOT BE ACCEPTED AS SUBSTITUTE FOR B&B MATERIAL UNLESS PREVIOUSLY APPROVED. INTENDED SUBSTITUTIONS SHALL BE SPELLED OUT IN BID.

MEASUREMENTS:

SHADE TREES: HEIGHT SHALL BE MEASURED FROM GROUND TO THE AVERAGE BRANCH HEIGHT OF CANOPY. SPREAD SHALL BE MEASURED TO THE END OF THE BRANCHING EQUALLY AROUND THE CROWN FROM THE CENTER OF THE TRUNK. MEASUREMENTS ARE NOT TO INCLUDE ANY TERMINAL GROWTH. SINGLE TRUNK TREES SHALL BE FREE OF "Y" CROTCHES THAT COULD BE POINTS OF WEAK LIMB STRUCTURE OR DISEASE INFESTATION.

SHRUBS: HEIGHT SHALL BE MEASURED FROM THE GROUND TO THE AVERAGE POINT WHERE MATURE PLANT GROWTH STOPS. SPREAD SHALL BE MEASURED TO THE END OF BRANCHING EQUALLY AROUND THE SHRUB MASS. MEASUREMENT AREA NOT TO INCLUDE ANY TERMINAL GROWTH.

PALMS: CLEAR TRUNK (CT.) SHALL BE MEASURED FROM THE GROUND AT THE POINT OF INSTALLATION TO THE POINT WHERE THE MATURE AGED TRUNK JOINS THE IMPURE OR GREEN PORTION OF THE TRUNK OR HEAD.

OVERALL HEIGHT (OAH) SHALL BE MEASURED FROM THE GROUND AT THE TIME OF INSTALLATION TO THE AVERAGE FROND HEIGHT.

PALMS WITH MARKED OR BURNED TRUNKS WILL NOT BE ACCEPTED.

PLANTING SOIL AND BACKFILL:

PLANTING SOIL FOR USE IN PREPARING BACKFILL FOR PLANT PITS SHALL BE A FERTILE, FRIABLE AND NATURAL TOPSOIL, WITHOUT MIXTURE OF SUBSOIL MATERIALS, AND SHALL BE FREE FROM HEAVY CLAY, STONES, LIMES, SHELLS, PLANTS, ROOTS OR OTHER FOREIGN MATERIALS, WEEDS, OR NOxious GRASSES (SUCH AS BERMUDA OR NUT GRASS). IT SHALL NOT CONTAIN TOXIC SUBSTANCES WHICH MAY BE HARMFUL TO THE PLANT GROWTH.

BACKFILL FOR SOIL AREAS SHALL BE SUBJECT TO LESSER STANDARDS AT THE DISCRETION AND DECISION OF THE OWNER.

EXISTING TOPSOIL SHALL BE USED IN ALL PLANT MATERIALS EXCEPT SABAL PALMS WHERE THE SOIL SHALL CONSIST OF CLEAN SAND.

PLANTING SOIL FOR USE IN BEDS FOR ANNUALS AND/OR PERENNIALS SHALL CONTAIN ONE-THIRD (1/3) POTTING SOIL OR A BLENDED TOPSOIL: FILL TOP 10" - 12" OF SOIL WITH A TIME-RELEASE FERTILIZER.

PLANT MATERIALS:

PALMS, TREES, SHRUBS, GROUNDCOVERS AND VINES
PLANT SPECIES & SIZES SHALL CONFORM TO THOSE INDICATED ON THE DRAWINGS. NOMENCLATURE SHALL CONFORM TO "STANDARDIZED PLANT NAMES", 1942 ED. ALL NURSERY STOCK SHALL BE IN ACCORDANCE WITH GRASSES AND STANDARDS FOR NURSERY PLANTS PARTS I & II, LATEST EDITION PUBLISHED BY THE FLORIDA DEPARTMENT OF AGRICULTURE AND CONSUMER SERVICES. UNLESS SPECIFIED OTHERWISE, ALL PLANT MATERIALS SHALL BE FLORIDA GRADE NUMBER 1 OR BETTER AS DETERMINED BY THE FLORIDA DIVISION OF PLANT INDUSTRY. SPECIFIC YEARS ARE EXCEPTIONALLY HEAVY SYMMETRICAL TWIGLY SOFT PLANT SO TRAINED OR FAVORABLE IN ITS DEVELOPMENT THAT FIRST APPEARANCE IS UNQUESTIONABLE & OUTSTANDINGLY SUPERIOR IN FORM, NUMBER OF BRANCHES, COMPACTNESS AND SYMMETRY. ALL PLANTS SHALL BE FRESHLY CUT, SOUND, HEALTHY, VIGOROUS, WELL BRANCHED AND FREE OF DISEASE AND INSECT EGGS AND LARVAE AND SHALL HAVE ADEQUATE ROOT SYSTEMS. TREES FOR PLANTING MUST BE UNIFORM IN SIZE AND QUALITY AND SHALL BE SUBJECT TO APPROVAL BY THE OWNER. WRITING REQUIREMENTS ARE OMITTED FROM THE PLANT LIST; THE PLANTS FURNISHED SHALL BE NORMAL FOR THE VARIETY AND FLORIDA NUMBER 1. PLANTS SHALL BE PRUNED PRIOR TO DELIVERY ONLY UPON THE APPROVAL OF THE OWNER.

CONTAINER GROWN STOCK:

1. ALL CONTAINER GROWN MATERIAL SHALL BE HEALTHY, VIGOROUS, WELL-ROOTED PLANTS AND ESTABLISHED IN THE CONTAINER IN WHICH THEY ARE SOLD. THE PLANTS SHALL HAVE TOPS OF GOOD QUALITY AND BE IN A HEALTHY GROWING CONDITION.
2. AN ESTABLISHED CONTAINER GROWN PLANT SHALL BE TRANSLANTED INTO A CONTAINER AND GROWN IN THAT CONTAINER SUFFICIENTLY LONG ENOUGH FOR THE NEW FIBROUS ROOTS TO HAVE DEVELOPED TO THE POINT WHERE THE ROOT MASS WILL RETAIN ITS SHAPE AND HOLD TOGETHER WHEN REMOVED FROM THE CONTAINER.

WARRANTY:

WARRANTY PLANTS, SHRUBS AND TREES FOR A PERIOD OF NINETY (90) DAYS AGAINST DEATH AND UNHEALTHY CONDITION EXCEPT AS MAY RESULT FROM NEGLIGENCE BY OWNER, DAMAGE BY OTHERS, AND UNUSUAL FAVORABLE WEATHERING CONDITIONS. REPLACEMENT AT THE REQUESTED BY THE OWNER OR LANDSCAPE ARCHITECT.

MAINTENANCE:

MAINTAIN LANDSCAPE WORK UNTIL THE LETTER OF SUBSTANTIAL COMPLETION BY THE GENERAL CONTRACTOR. INCLUDE WATERING, WEEDING, CULTIVATING, RESTORATION OF GRADE, MOULDS AND TRIPPING GRASS, PRUNING TREES AND SHRUBS, PROTECTION FROM INSECTS AND DISEASES, FERTILIZATION AND SIMILAR OPERATIONS AS NEEDED TO ENSURE NORMAL GOOD HEALTH FOR LIVE PLANT MATERIAL.

LAY-OUT NOTES:

1. CONTRACTOR SHALL VERIFY ALL EXISTING CONDITIONS AND LAYOUT DIMENSIONS IN THE FIELD AND DIRECTOR PRIOR TO CONSTRUCTION.
2. REFER TO ARCHITECTURAL DRAWINGS FOR ALL BUILDING DIMENSIONS.
3. CONTRACTOR SHALL VERIFY ALL EXISTING GRADES IN THE FIELD AND REPORT ANY DISCREPANCIES IMMEDIATELY TO THE LANDSCAPE ARCHITECT FOR REVIEW AND DIRECTION.
4. ALL FILL FOR BRIDGING 4" PLANTING BENCHES TO THE SITE SHALL BE CLEAN, FRIABLE SANDY LOAM OF SLIGHTLY ACID TO NEUTRAL PH. ALL FILL TO BE FREE FROM ROCKS, MARL, SOD & ALL OTHER DEBRIS.
5. REMOVE ALL ROAD BASE, CRUSHED CONCRETE, SHALLOO, MARL, CORAL ROCK & REBELLER MIN. SOD BELOW FINISH GRADE FOR ALL NEW PLANTING AREAS AND TREE PITS. BACKFILL WITH SUITABLE SOIL AS APPROVED BY LANDSCAPE ARCHITECT. MAINTAIN EXISTING GRADE AT EXISTING TREES.
6. NEW BRIDGING SHALL BLEND SMOOTHLY INTO EXISTING GRADE.
7. SLOPE EVENLY BETWEEN PLOT GRADERS. ALL PAVED AREAS MUST SLOPE TO DRAIN AT MINIMUM OF 1/8" PER FOOT. ANY SITE CONDITIONS WHICH PREVENT THIS FROM OCCURRING SHALL BE REPORTED TO THE LANDSCAPE ARCHITECT PRIOR TO CONSTRUCTION.
8. CONTRACTOR SHALL PROVIDE IRRIGATION AND ELECTRIC SLEEVES TO ALL PLANTERS.

DRAINAGE NOTES:

1. MATCH ALL EXISTING GRADES ALONG SIDE PROPERTY LINES TO ADJACENT LOT GRADERS.
2. PROVIDE SLEEVES ON BOTH SIDE PROPERTY LINES. NO WATER SHALL DRAIN INTO NEIGHBORING PROPERTIES.
3. CONTRACTOR SHALL BE RESPONSIBLE FOR PROVIDING POSITIVE DRAINAGE AWAY FROM ALL STRUCTURES INCLUDING, BUT NOT LIMITED TO, BUILDINGS, PLANTERS, COURTYARD PLANTING AREAS, LANDSCAPE SURFACES AND ARCHITECTURAL ELEMENTS.
4. CONTRACTOR SHALL PROVIDE PIPED DRAINAGE FROM ALL CONFINED PLANTING AREAS & PLANTERS.

EXHIBIT "B"

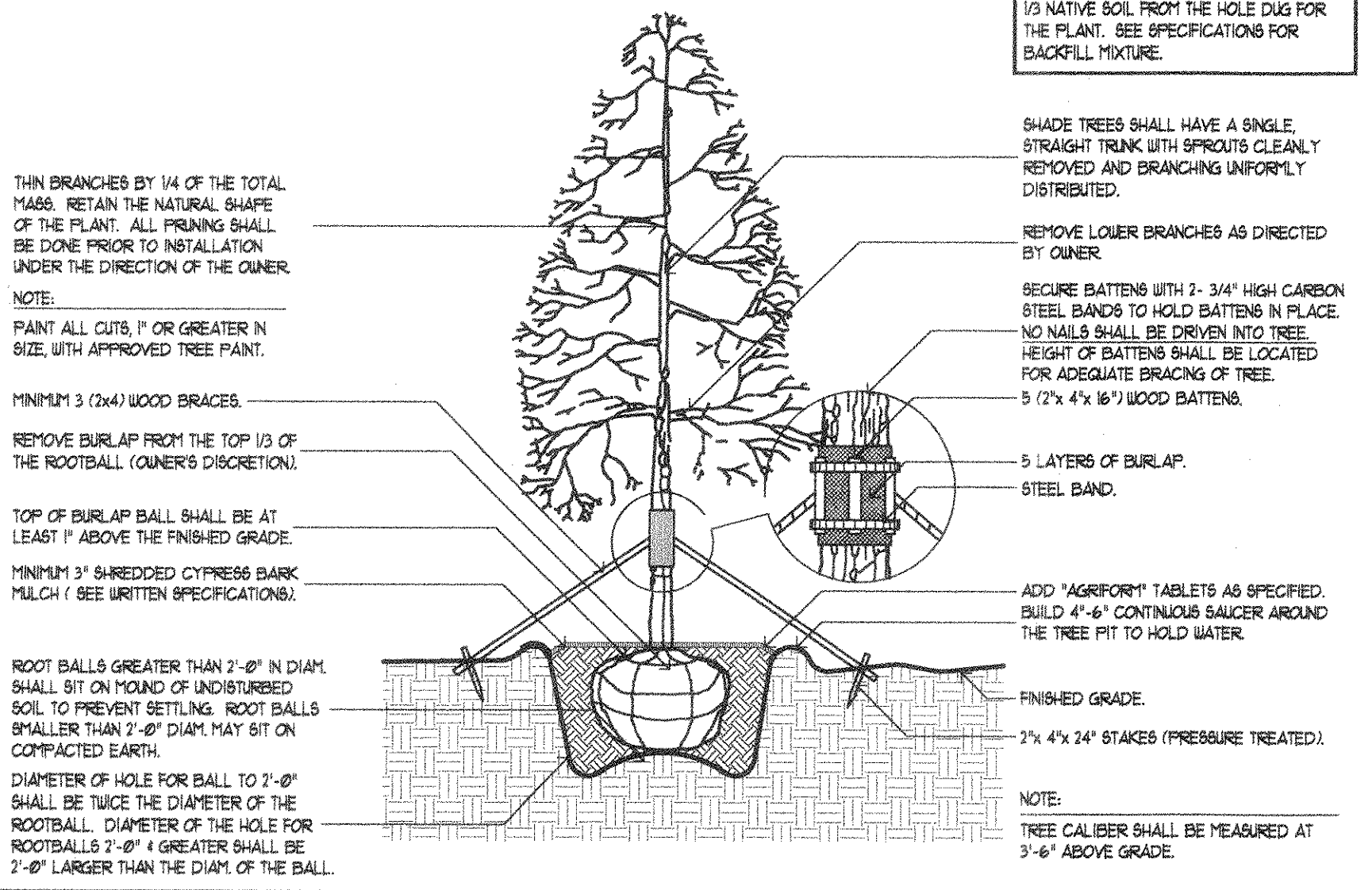

Tree Planting

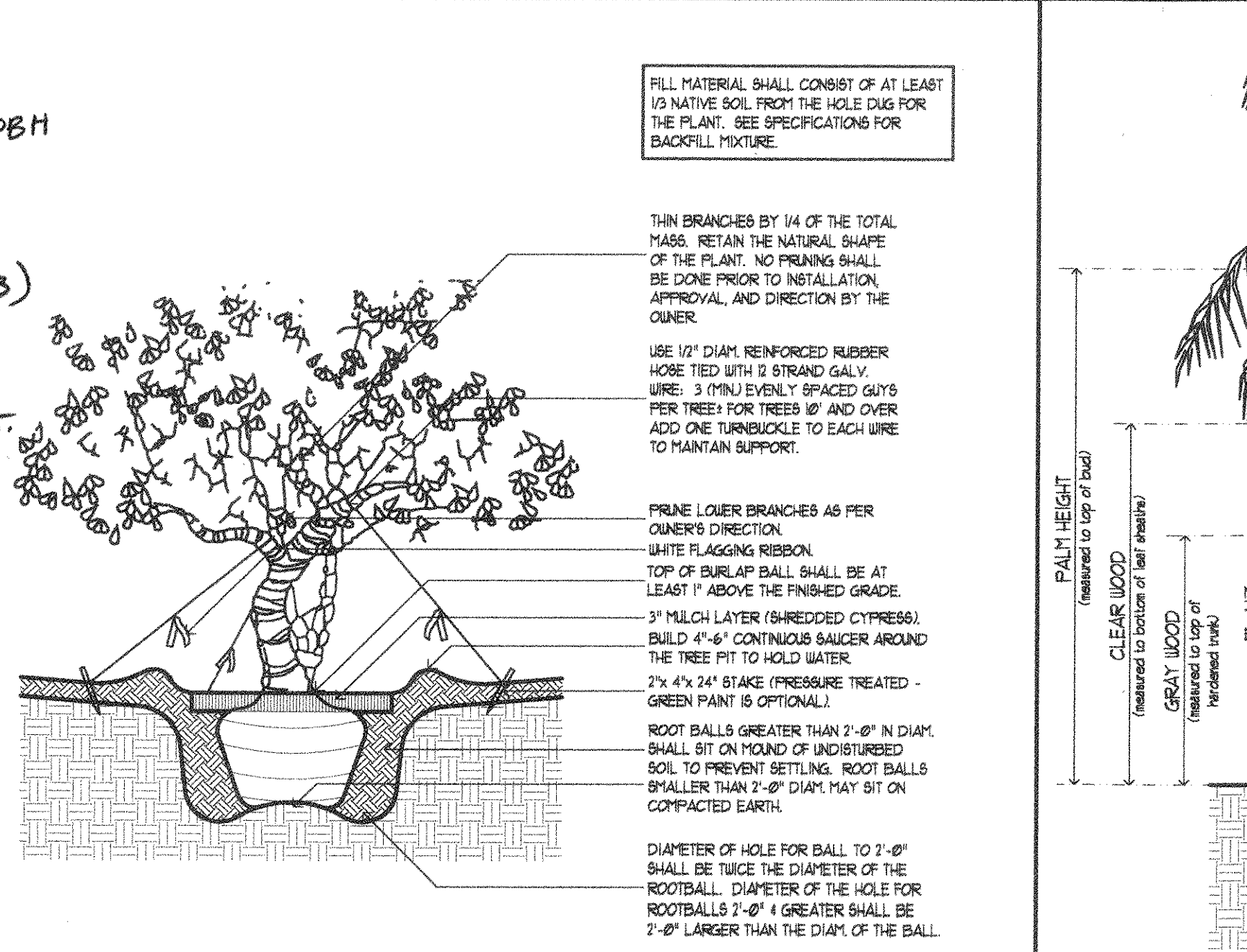

Irregular and Multi-stem Tree

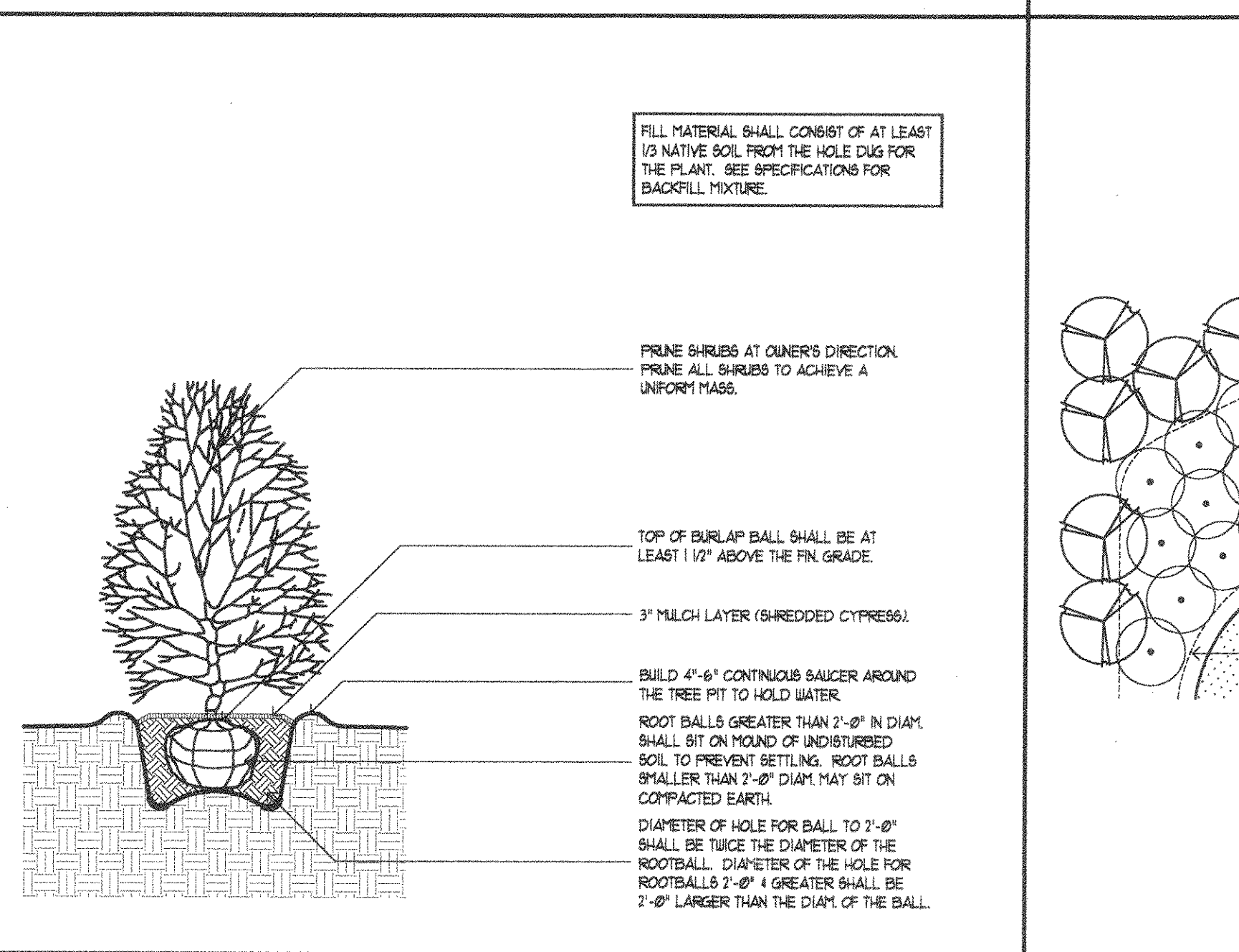

Shrub Planting

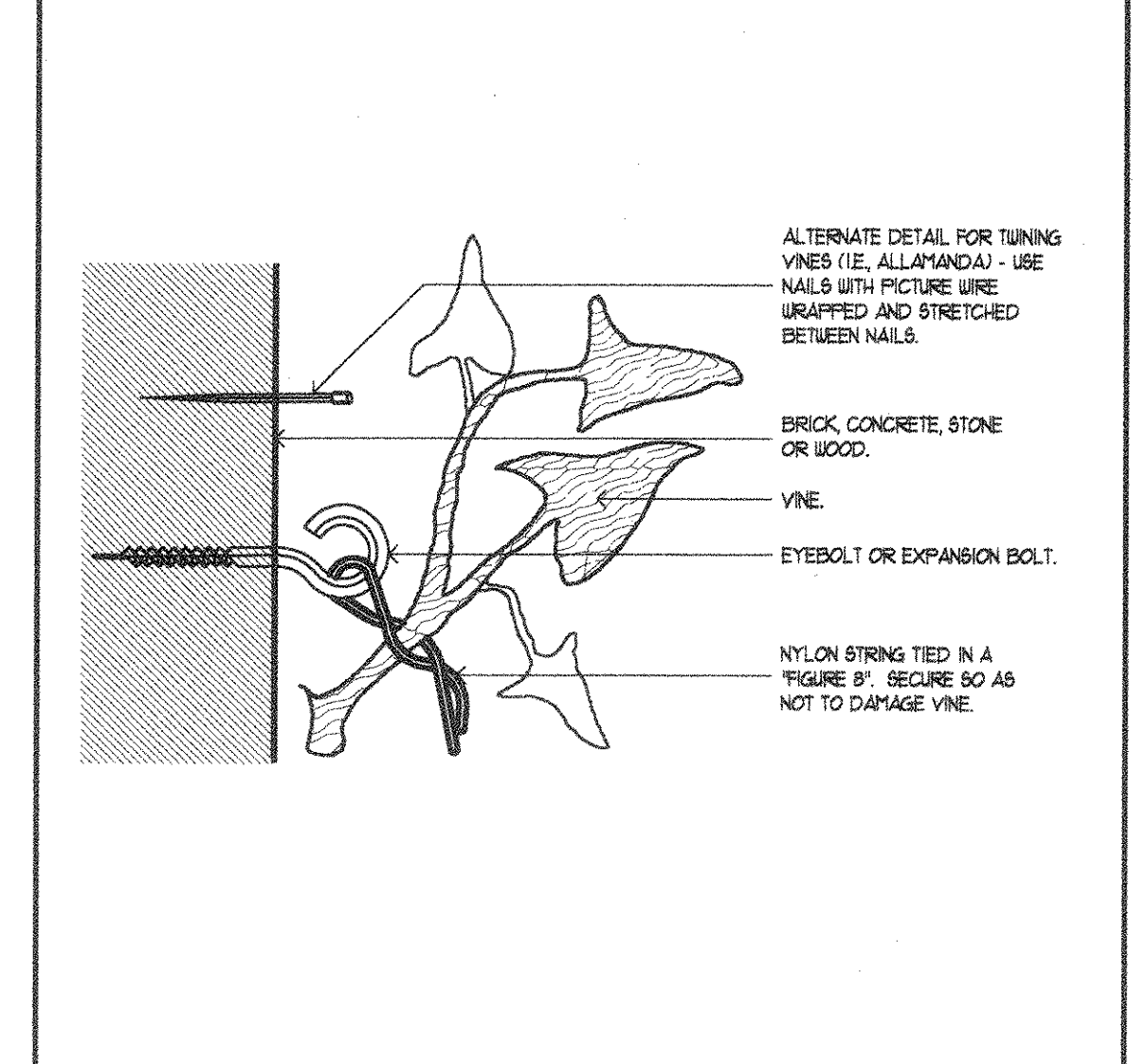

Vine Attachment

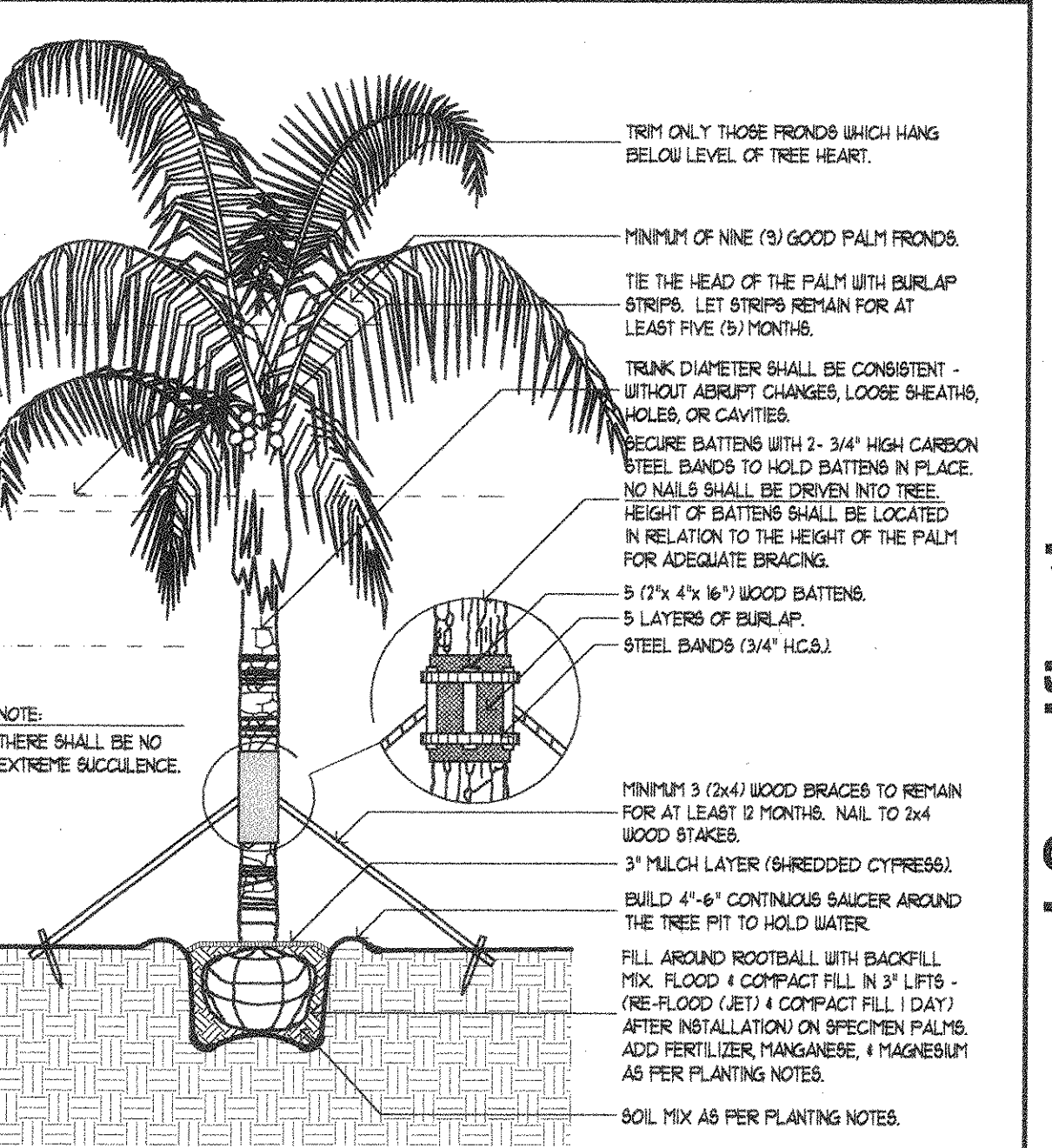

Palm Tree Planting

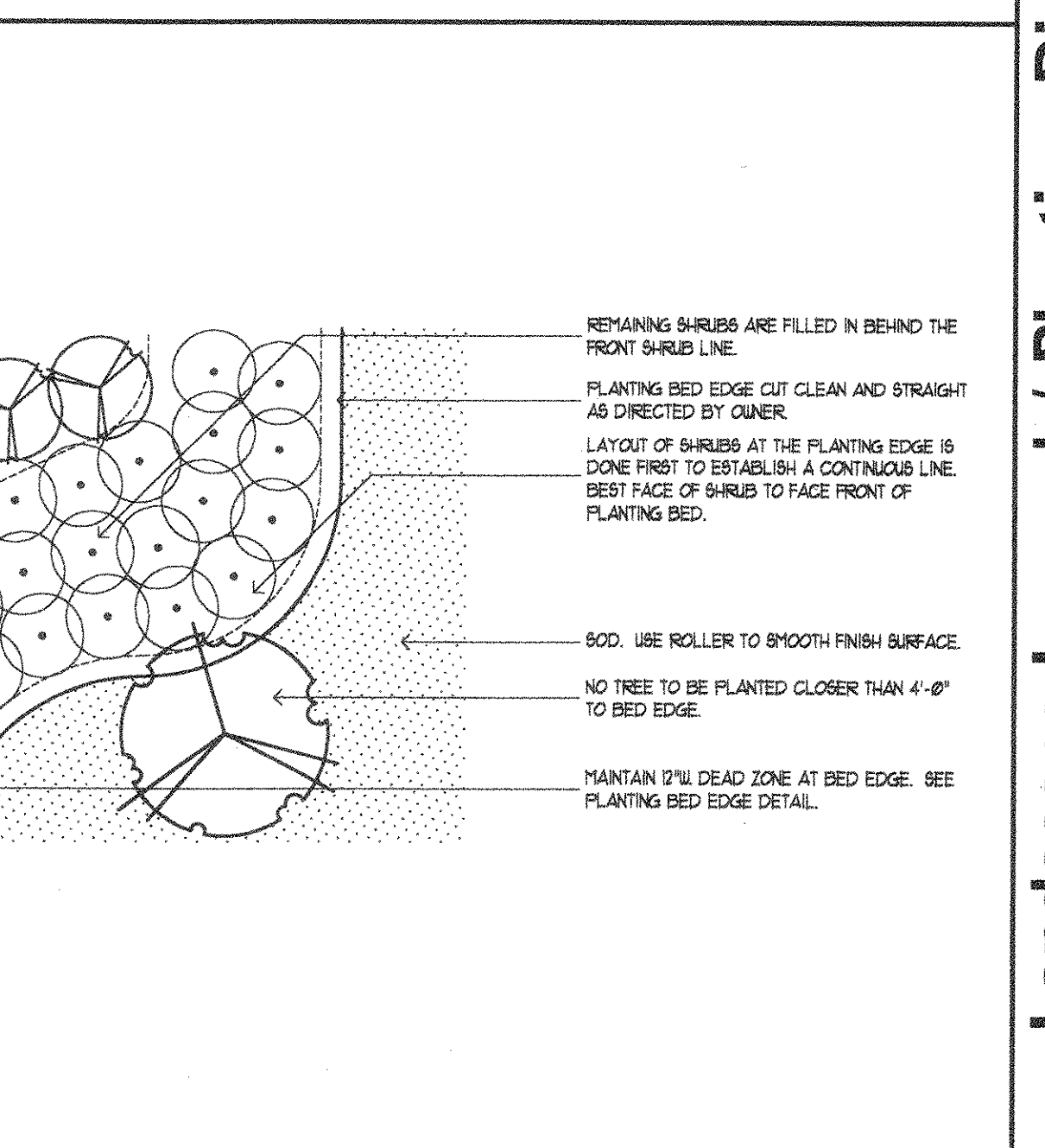

Shrub and Ground Cover Lay-out

REVISIONS	BY
7-29-15	HFO

Howard F. Ostrout Jr.
Registered Landscape Architect
Florida Certificate No. 449

Howard F. Ostrout Jr., and Associates, LLC
Landscape Architecture • Urban Design
Jupiter, Florida 33468
Web Site www.ostrout.com
E-mail howard@ostrout.com

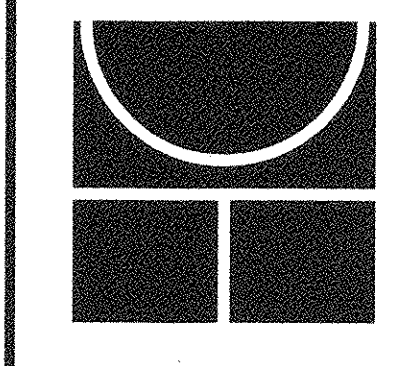

Landscape Specifications & Planting Diagrams
Allied Trailer Sales
Riviera Beach, Florida
49th Terrace North

DRAWN	KPK/HFO
DATE	4 MAY 2015
SCALE	AS NOTED
JOB NO.	50401
SHEET	

LPP-2
of 2

Landscape Legend / Planting Diagrams and Specifications