

SR	DATE	BY	COMMENTS
1	8/25/20		ADDRESS CITY COMMENTS
2	12/1/20		ADDRESS CITY COMMENTS

THIS PLAN SET IS FOR PERMITTING PURPOSES ONLY AND MAY NOT BE USED FOR CONSTRUCTION

DRAWN BY: SUB
 CHECKED BY: SUB
 DESIGNED BY: SUB
 AP

Site Plan
Tractor Supply Company
 City of Riviera Beach, Florida

DYNAMIC ENGINEERING

LAND DEVELOPMENT CONSULTING • PERMITTING
 GEOTECHNICAL • ENVIRONMENTAL
 TRAFFIC • SURVEY • PLANNING & ZONING

100 NE 5th Avenue, Suite B2
 Delray Beach, FL 33483
 T: 561.921.8570

Offices conveniently located at:
 Lake County, New Jersey • 1.732.974.0118
 Chester, New Jersey • 1.800.919.0209
 Newark, New Jersey • 1.973.755.2200
 Tampa Bay, New Jersey • 1.732.974.0219
 Washington, Pennsylvania • 1.202.465.0274
 Allen, Texas • 1.926.584.9700
 Houston, Texas • 1.281.399.4400
 Austin, Texas • 1.512.446.5444
 Delray Beach, Florida • 1.561.921.8570

Florida Certificate of Authorization No. 32335
 www.dynamicce.com

811 PROTECT YOURSELF

ALL STATES REQUIRE NOTIFICATION OF ENGINEERS, DESIGNERS, OR ANY PERSON PREPARING TO DIG INTO THE EARTH'S SURFACE ADVANCE IN ANY STATE

Know what's below
 Call before you dig

FOR STATE SPECIFIC DIRECT PHONE NUMBERS VISIT: WWW.CALL811.COM

TITLE: **LANDSCAPE DETAILS**

SCALE: (H) AS NOTED DATE: 06/5/2020

PROJECT No: 20-020.02

SHEET No: LP-2 Rev. #: 0

CANOPY TREE PLANTING NOTES:

- EACH TREE SHALL RECEIVE SIX "AGRIFORM" 21 GRAM TABLETS PER MANUFACTURER'S DIRECTIONS.
- ALL TREES SHALL HAVE A MINIMUM CLEARANCE OF 15' FROM LIGHT POLES, AND SHALL NOT BE INSTALLED WITHIN 10 FT. OF ANY ABOVE GROUND UTILITIES OR WITHIN 30 FT. OF THE FACE OF A STOP SIGN.
- ALL TREE TRIMMING SHALL BE IN ACCORDANCE WITH LOCAL CODES AND THE AMERICAN NATIONAL STANDARD INSTITUTE (ANSI) A-300 PRUNING STANDARDS.

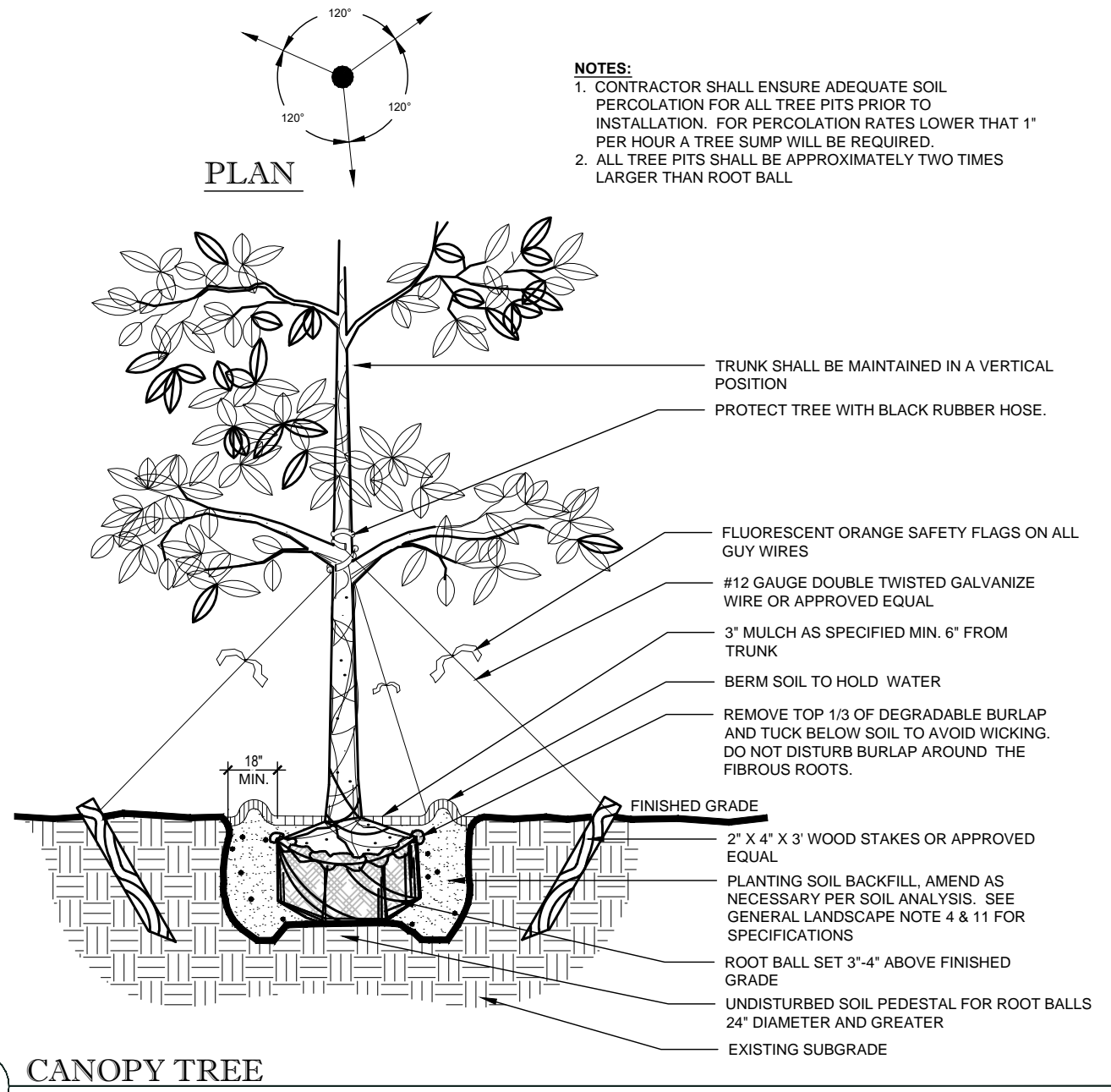

1 CANOPY TREE
 SCALE: NTS

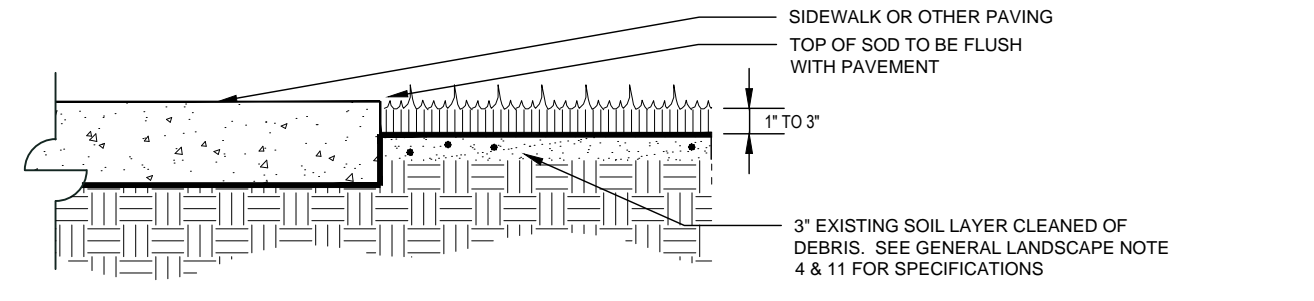

2 SOD APPLICATION
 SCALE: NTS

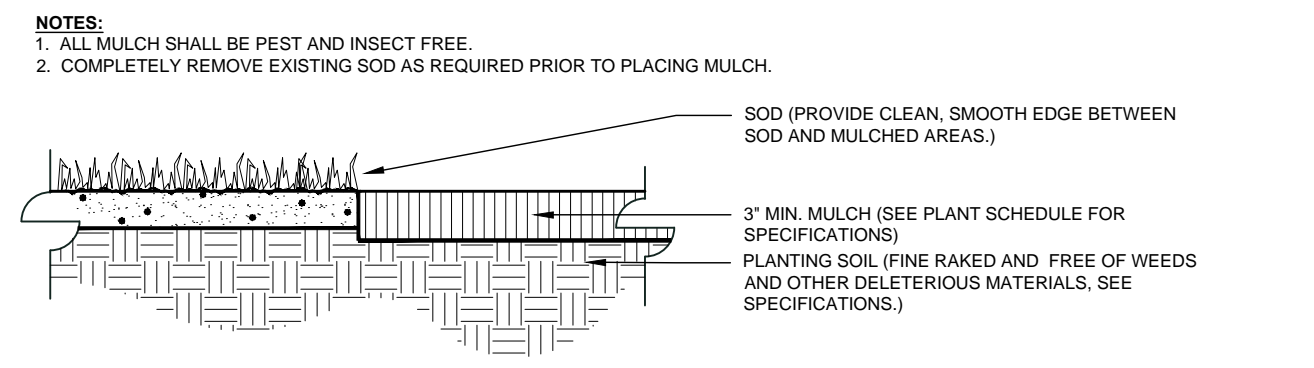

3 MULCH APPLICATION
 SCALE: NTS

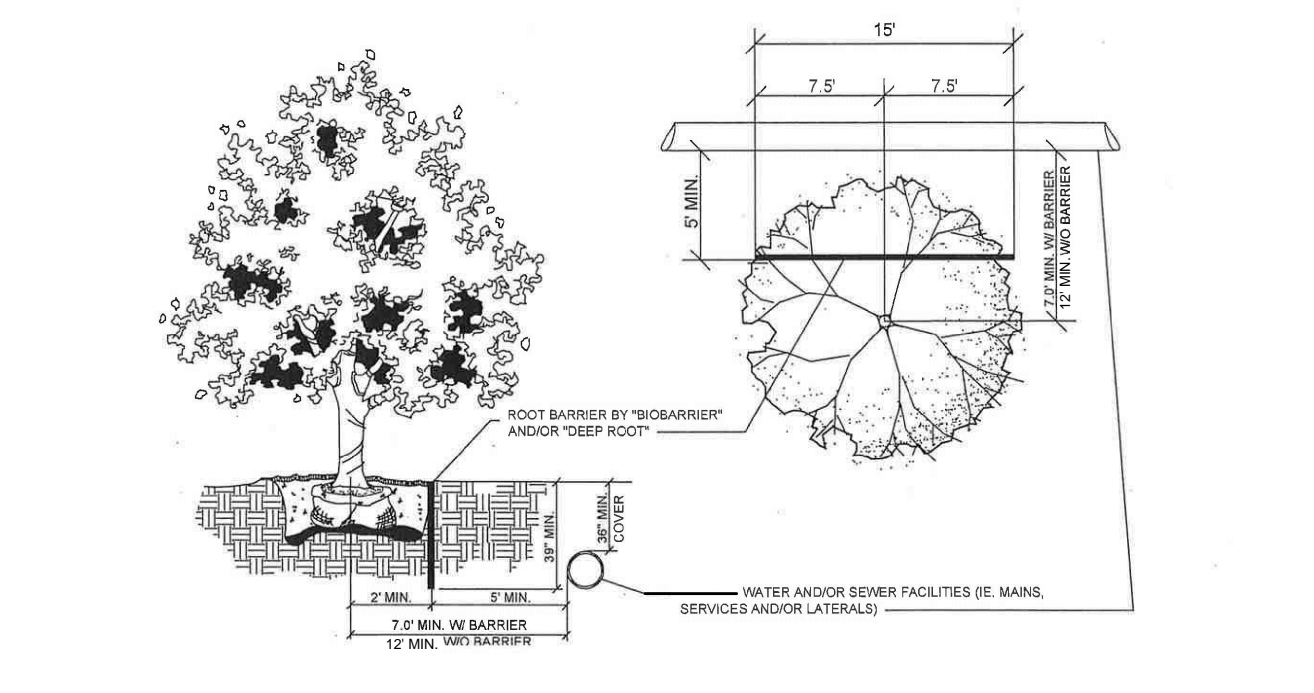

4 LANDSCAPE ROOT BARRIER DETAIL
 SCALE: NTS

- NOTES:**
- CONTRACTOR SHALL ENSURE FREE DRAINAGE/PERCOLATION OF ALL PLANTING PITS/BEDS PRIOR TO INSTALLATION.
 - ALL PLANTING PITS SHOULD HAVE VERTICAL SIDES AND BE APPROXIMATELY TWO TIMES LARGER THAN ROOT BALL.
 - PLANT MATERIAL SHALL BE INSTALLED 2" HIGH WITH SOIL, MOUNDING UP TO THE TOP OF ROOT BALL.
 - WHERE GROUND COVERS ARE USED IN MASSES, THE ENTIRE BED SHALL BE EXCAVATED PRIOR TO RECEIVING PLANT MATERIAL AND PLANTING SOIL EXCEPT WHERE SPECIFIED.
 - ALL PLANT MATERIAL MASSES TO USE TRIANGULAR SPACING EXCEPT WHERE NOTED. REFER TO PLANT LIST FOR INDIVIDUAL PLANT SPACING 'X'.
 - PLANT MATERIAL INSTALLED ADJACENT TO STRAIGHT EDGES SHALL BE SPACED IN ROWS PARALLEL TO THE STRAIGHT EDGE. THOSE INSTALLED ADJACENT TO CURVED EDGES SHALL BE PLANTED IN ROWS PARALLEL TO THE CURVED EDGE

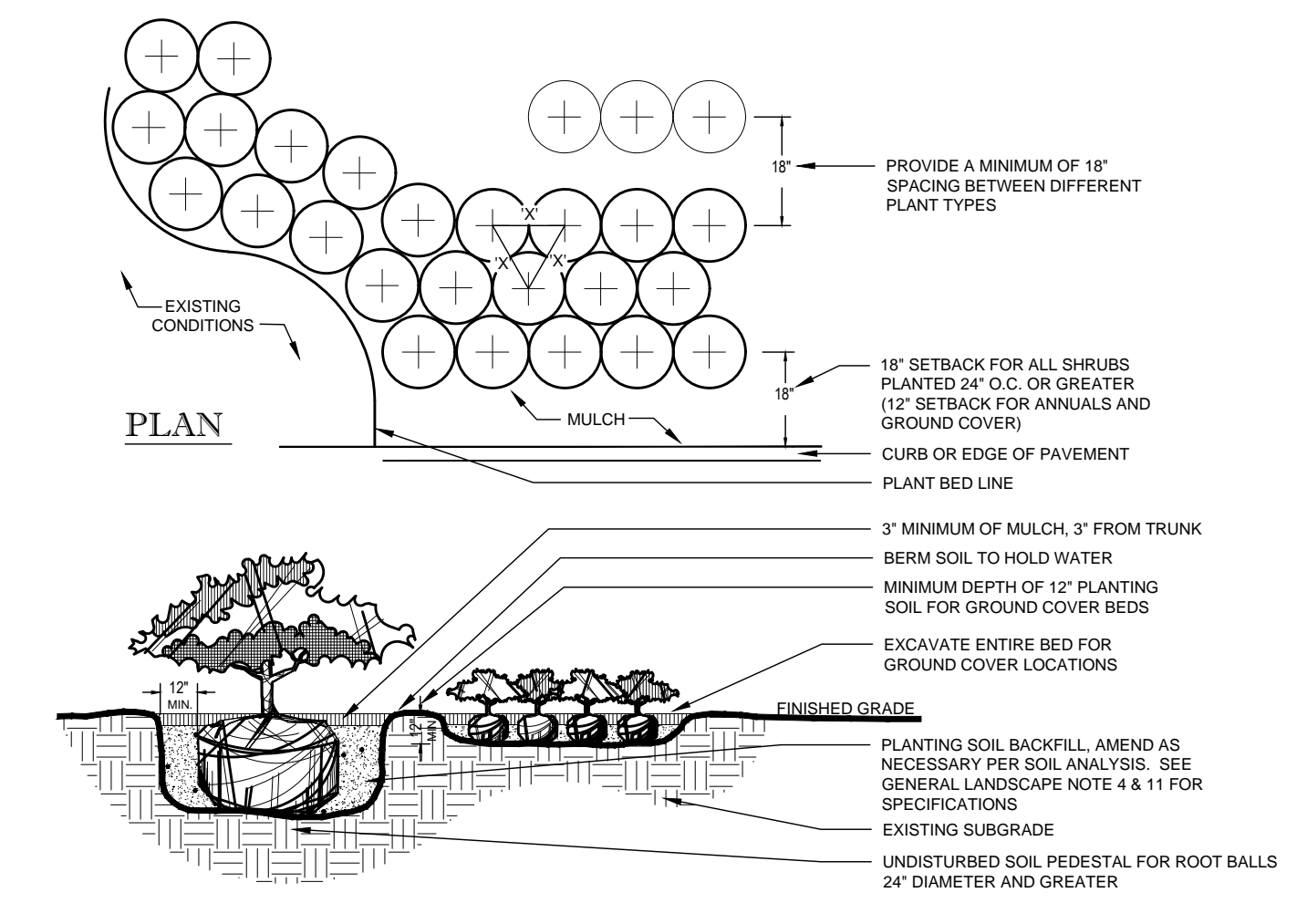

5 SHRUB AND GROUND COVER
 SCALE: NTS

PLANT SCHEDULE

SYMBOL	QTY.	BOTANICAL NAME	COMMON NAME	SPECIFICATIONS (Minimums)
TREES				
7 MITIGATION	QV*	28 Quercus virginiana	Live Oak	12' Ht x 5' Spr x 2.5" Cal, 6' Ct
	BS*	20 Bursera simaruba	Gumbo Limbo	12' Ht x 5' Spr x 2.5" Cal, 6' Ct
	CD*	33 Cocoloba diversifolia	Pigeon Plum	10' Ht x 5' Spr x 1.5" Cal, 5' Ct
	IA*	11 Ilex x attunata 'Eagleston'	Eagleston Holly	12' Ht x 5' Spr x 2.5" Cal, 6' Ct
PALMS				
	AD	13 Adonidia merrillii	Christmas Palm	10' Ct, Triple Trunk (1:1 Credits)
	SP*	9 Sabal Palmetto	Sabal Palm	Heights on Plan, Slick (3:1 credit)
59 RELOCATED	SPR*	59 Sabal Palmetto	Sabal Palm	Field Relocated to East Buffer
SHRUBS				
	CES*	204 Conocarpus erectus sericeus	Silver Buttonwood	7G, 36" x 24", 30" On Center
	TRI*	47 Tripsacum dactyloides	Fakahatchee Grass	3G, 24"x24", 48" On Center
	CHR1*	241 Chrysobalanus icaco 'Red Tip'	Red Tip Cocoplum	7G, 36" x 24", 30" On Center
	CHR*	214 Chrysobalanus icaco 'Red Tip'	Red Tip Cocoplum	3G, 24" x 24", 30" On Center
	CRI	9 Crinum asiaticum	Crinum Lily	15G, 36" x 24", 30" On Center
	CHH*	225 Chrysobalanus horizontalis	Horizontal Cocoplum	3G, 18" x 24", 36" On Center
	FIM	261 Ficus microcarpa	Green Island Ficus	3G, 18" x 18", 24" On Center
	ZAM*	49 Zamia integrifolia	Coontie	3G, 18" x 18", 24" On Center
	COC*	299 Cocoloba uvifera	Sea Grape	7G, 24" x 24", 36" On Center
	POM	125 Podocarpus macrophyllus	Podocarpus	3G, 24" x 18", 24" On Center
GROUND COVER				
	HEL*	118 Helianthus debilis	Beach Sunflower	1G, 12"x12" SPR, 16" On Center
	LIM	1457 Liriope muscari	Lilyturf	1G, 8" x 8" Full, 16" On Center
	CAR*	448 Carissa macrocarpa	Dwarf Carissa	1G, 12" X 6" Full, 24" On Center
LAWN GRASS				
	SOD	32,600 SF **	Paspalum notatum	Argentine Bahiagrass
	SEED	16,000 SF **	Paspalum notatum	Argentine Bahiagrass
MULCH				
	MULCH	**	3" Layer of double ground hardwood	

* NATIVE SPECIES - HIGH DROUGHT TOLERANCE (OTHERS MEDIUM DROUGHT TOLERANCE)
 ** CONTRACTOR TO VERIFY QUANTITY

GENERAL PLANTING NOTES:

- NUISANCE, EXOTIC PLANT SPECIES REMOVAL SHALL BE COMPLETED IN ACCORDANCE WITH SECTIONS OF THE MUNICIPAL REGULATIONS, GUIDELINES AND STANDARDS.
- ALL PLANT MATERIAL SHALL BE FLORIDA NO. 1 OR BETTER, AS SET FORTH BY THE LATEST EDITION OF FLORIDA GRASSES AND STANDARDS.
- PLANT MATERIAL SHALL BE LOCAL FLORIDA NURSERY STOCK.
- THE LANDSCAPE CONTRACTOR SHALL NOTIFY THE OWNER OF ANY IMPROPER SOIL CONDITIONS (WETNESS, MUCK, DEBRIS, ETC.) PRIOR TO INSTALLATION. THE CONTRACTOR IS RESPONSIBLE FOR ALL SOIL AMENDMENTS AND/OR FERTILIZER RECOMMENDED BY THE REQUIRED SOIL ANALYSIS REPORT FOR HEALTHY, VIGOROUS PLANT GROWTH. SEE NOTE 11.
- ALL PLANT MATERIAL HOLES SHALL BE HAND DUG EXCEPT WHERE MACHINE DUG HOLES WILL NOT ADVERSELY AFFECT OR DAMAGE UTILITIES OR PROJECT IMPROVEMENTS.
- THE LANDSCAPE CONTRACTOR SHALL BE RESPONSIBLE FOR MAINTAINING ALL LANDSCAPE ELEMENTS UNTIL CONSTRUCTION IS COMPLETE AND ACCEPTED BY THE OWNER'S REP. THIS MAINTENANCE SHALL INCLUDE BUT MAY NOT BE LIMITED TO MOWING, EDGING AND TRIMMING GRASS, KEEPING PLANTING BEDS FREE OF DEBRIS AND WEEDS, MANAGING ALL DISEASE OR INFESTATION, WATERING OF PLANT MATERIALS, AND MAINTAINING MULCH.
- ALL PLANT MATERIAL SHALL BE GUARANTEED FOR A PERIOD OF 1 YEAR FROM THE DATE OF COMPLETION OF CONSTRUCTION.
- PRIOR TO CONSTRUCTION, THE CONTRACTOR SHALL VERIFY AND STAKE ALL UTILITIES. A MINIMUM OF TEN FEET SEPARATION IS REQUIRED BETWEEN UTILITIES AND TREE PLANTINGS. IN ADDITION, ALL TREES SHALL BE LOCATED AT LEAST SIX FEET AWAY FROM THE FLOW LINE OF SWALES AND PROPOSED OR EXISTING STORM WATER INLETS.
- NEW PLANT MATERIAL TO BE INSTALLED WILL BE FIELD ADJUSTED TO ACCOMMODATE EXISTING PLANT MATERIAL SUCH AS OVERHEAD CANOPY TREES, UNDER-STORY TREES AND SHRUBS OR GROUND COVER. THIS WILL ENSURE EXISTING PLANT MATERIAL TO REMAIN IN ITS NATURAL STATE. THEREFORE, NO EXISTING PLANT MATERIAL WILL BE ALTERED BY REMOVING, CUTTING TRIMMING OR DESTROYING IN ORDER TO INSTALL NEW PLANT MATERIAL.
- ALL PLANT MATERIALS TO BE CONTAINER GROWN UNLESS OTHERWISE SPECIFIED. BAG GROWN PLANTS ARE NOT ACCEPTABLE.
- THE PLANTING SOIL USED IN THE PLANTING OPERATIONS SHALL BE A MIXTURE OF 2 PARTS EXISTING TOPSOIL AND 1 PART CLEAN SAND. THE EXISTING TOPSOIL SHALL BE TESTED AND CONSIST OF NATURAL, FRIABLE, FINE LOAM SOIL WITH A pH OF 5.5 TO 7.0, AND 3-5% ORGANIC MATTER. IT SHALL BE FREE OF WEED SEEDS, PATHOGENS, LITTER, SOD, CLAY, ROAD BASE, STONES, ROOTS AND STUMPS. SOIL DEPTH SPECIFIED ON THE PLANS IS MEASURED AFTER LIGHT COMPACTION. TOP SOIL THAT DOES NOT MEET THIS SPEC SHALL BE SUBSTITUTED WITH PROPER BORROW SOIL. SEE NOTE 4.
- BED PREPARATION: LOOSEN SOIL TO A MINIMUM DEPTH OF TWELVE INCHES AND REMOVE ALL DEBRIS. RE-GRADE THE BED TO ITS ORIGINAL GRADE. DIG PLANTING PITS AT 2 TIMES THE DIAMETER OF THE POT. FILL PLANT PIT WITH SPECIFIED PLANTING MIX AND COMPACT SO THAT THE TOP OF ROOT BALL WILL SETTLE 1/8 DEPTH OF THE ROOT BALL ABOVE FINISH GRADE. SET PLANT AND FILL REMAINDER OF HOLE WITH PLANTING MIX. FERTILIZE EACH PLANT WITH THE RECOMMENDED RATE BASED ON SOIL ANALYSIS AND RECOMMENDATIONS. WATER IN THOROUGHLY. RESET ANY PLANTS THAT SETTLE TOO DEEP. REMOVE SPOIL SOIL AND RAKE THE BED TO ITS FINISH GRADE.
- MULCH ALL BED AREAS WITH A 3" DEPTH OF APPROVED ORGANIC MULCH, ENSURE MULCH OVER ROOT BALLS DOES NOT EXCEED A DEPTH OF ONE INCH. REMOVE ALL DEBRIS FROM THE MULCH. WATER BED THOROUGHLY. THE USE OF CYPRESS MULCH IS PROHIBITED. ALL TREES NOT LOCATED WITHIN A PLANTING BED SHALL RECEIVE A FOUR FEET DIAMETER MULCH RING.
- THE LANDSCAPE CONTRACTOR SHALL BE RESPONSIBLE FOR HOLDING THE FINE GRADING OF PLANTING AREAS TO ENSURE AT LEAST THREE PERCENT POSITIVE DRAINAGE AWAY FROM BUILDINGS AND INTO TURF AREAS, PONDS, STREETS OR OTHER DRAINAGE WAYS. IN ADDITION, THE FINISH MULCH ELEVATION AT THE BUILDINGS SHALL BE AT LEAST SIX INCHES BELOW FINISH FLOOR OF THE ADJACENT BUILDING. PARKING LOT ISLANDS SHALL SLOPE AT THREE PERCENT FROM CENTER. TURF AND PLANTING BEDS SHALL MEET SIDEWALKS AND FLATWORK AT TWO INCHES BELOW THE FLATWORK.
- SLOPES GREATER THAN 4:1 SHALL REQUIRE SODDING FOR STABILIZATION.
- ANY AREAS SUBJECT TO EROSION MUST BE ADEQUATELY STABILIZED WITH VEGETATIVE MATERIAL THAT WILL, WITHIN A REASONABLE TIME FRAME, DETER SOIL DISTURBANCE. SODDING, PLUGGING, SPRIGGING OR SEEDING IS ACCEPTABLE FOR STABILIZATION; HOWEVER, SODDING MAY BE REQUIRED IN AREAS OF EROSION-PRONE SOILS OR WHERE SLOPES ARE GREATER THAN 5:1. VEGETATION OTHER THAN GRASS IS ACCEPTABLE AND MAY BE UTILIZED AT THE OWNERS DISCRETION.
- IF ALTERNATIVE VEGETATION IS UTILIZED (I.E. MATCHING AND/OR EXTENDING EXISTING SHRUB BED, THE INSTALLED MATERIAL MUST BE HEALTHY, VIGOROUS MATERIAL, FREE OF PESTS AND DISEASES. ALL PLANT MATERIAL SHALL BE IN FULL AND STRICT ACCORDANCE TO FLORIDA NO. 1 GRADE, ACCORDING TO THE GRASSES AND STANDARDS FOR NURSERY PLANTS, PUBLISHED BY THE FLORIDA DEPARTMENT OF AGRICULTURE AND CONSUMER SERVICES. MATERIAL IN SOME INSTANCES SHALL EXCEED NO. 1 GRADE, IN ORDER TO MEET THE MINIMUM REQUIREMENTS OF THIS PROJECT.
- SOD SHALL BE INSTALLED IN ALL DISTURBED LANDSCAPE AREAS THAT ARE NOT PLANTED OR HARDCAPPED. CONTRACTOR SHALL VERIFY SOD QUANTITY.
- LANDSCAPE CONTRACTOR SHALL REPAIR, RELOCATE AND/OR REPLACE ANY CONSTRUCTION DAMAGED OR REMOVED LANDSCAPE MATERIALS, ON OR OFF SITE, THAT ARE NOT DELINEATED ON THE DEMOLITION PLANS. CONTRACTOR SHALL OBTAIN APPROVAL FROM OWNER'S REP. PRIOR TO ANY REMEDIATION LANDSCAPE EFFORTS.

LANDSCAPE AND ROOT BARRIER NOTES:

TREE LOCATION AND SPACING IS BASED ON DESIGN REQUIREMENTS AND THE TREES SHOWN ON THIS PLAN ATTEMPT TO ACCOMPLISH SPACING REQUIREMENTS WHILE MAINTAINING THE REQUIRED SETBACKS FROM UTILITIES. IN ANY CASE THE TREES SHALL BE PLANTED IN ACCORDANCE WITH THE PLANT DETAILS SHOW HEREON.

ADDITIONALLY, TREES ARE TO BE INSTALLED WITH A TWELVE FOOT (12) SEPARATION FROM ANY WATER OR SEWER MAIN AND/OR SERVICE, HYDRANTS, AND LIFT STATIONS. IF A TWELVE FOOT (12) CLEARANCE CANNOT BE ACHIEVED, SPACING CAN BE REDUCED TO SEVEN FOOT (7) IF INSTALLED WITH A ROOT BARRIER SYSTEM. REFER TO THE "ROOT BARRIER" DETAIL (THIS SHEET) FOR INSTALLATION REQUIREMENTS. HOWEVER, IN NO CASE SHALL A TREE ENCROUGH INTO AN EASEMENT WITHOUT PRIOR APPROVAL AND ONLY SOD CAN BE INSTALLED WITHIN 7.5 FEET OF A FIRE HYDRANT UNLESS OTHERWISE APPROVED BY THE FIRE MARSHAL AND CITY UTILITIES DEPARTMENT.

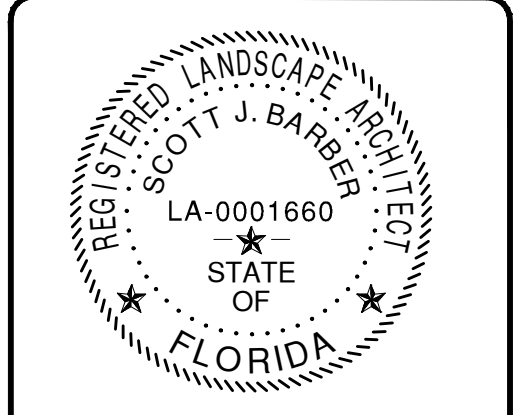

SCOTT BARBER DESIGNS P.A.

LANDSCAPE ARCHITECTURE & PLANNING
 LC-26000593

1551 WYNDCLIFF DRIVE
 WELLINGTON, FL 33414
 (561) 369-7263